

## Safety – Operation – Maintenance

Keep this document in a safe place

Read and understand this manual before operating your air tool



# Clear Revolution Drill Guides



**Slip Fixed Models:** 674-A1316-08SF 674-A1332-08SF

Designed for 1/2 x 3/4" Slip Fixed Drill Bushings

**Threaded Models:** 674-A1316-08T, 674-A1232-08T

Designed for 1/2-13 Threaded Drill Bushings

**Threaded Models:** 674-A1316-12T, 674-A1232-12T

Designed for 3/4-16 Threaded Drill Bushings

**No Bushing Models:** 674-A1316-12X, 674-A1232-12X

Designed for Drilling without Bushings



Scan this QR code for online instructions and documentation, or visit [www.ClaytonHowTo.com](http://www.ClaytonHowTo.com)

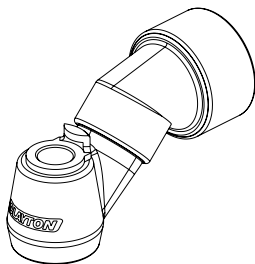

Slip Fixed

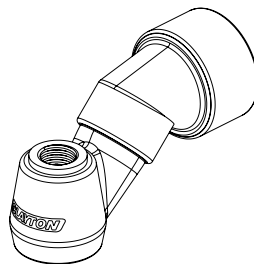

Threaded 1/2"

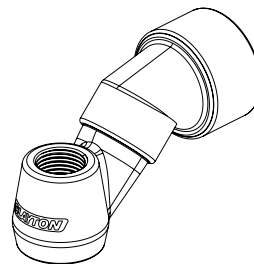

Threaded 3/4"

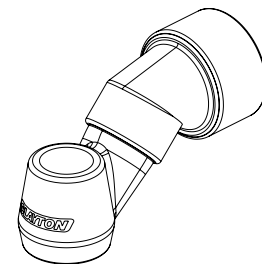

Open

## ⚠ WARNING

Follow all safety rules for the protection of operating personnel as well as adjacent areas. Always inspect and maintain this tool before use. Clayton Dust Collection Shrouds are designed for use with a variety of air tools. Please refer to the Air Tool Manufacturer's Documentation for Safety, Operations and Maintenance of all air tools used in conjunction with Clayton Dust Collection Shrouds.

### SAFETY LEGEND



#### ⚠ WARNING

Read and understand operator's manual before using this equipment.



#### ⚠ WARNING

Eye protection is required when operating this equipment.



#### ⚠ WARNING

Hearing protection is recommended when operating this equipment.



#### ⚠ WARNING

Respiratory protection is recommended when operating this equipment.

## ⚠ WARNING

Some dust created by sanding, grinding, drilling, and other construction activities contain chemicals known to cause cancer, birth defects or other reproductive harm. Some examples of these chemicals are:

- Lead from lead-based paints
- Crystalline silica from bricks and cement and other masonry products
- Chromium and other heavy metals from paint and primers

Your risk from these exposures varies, depending on how often you do this type of work. To reduce your exposure to these chemicals: work in a well ventilated area, and work with approved safety equipment, such as dust masks that are specially designed to filter out microscopic particles.

Clayton Dust Collection Shrouds aid in the collection of airborne dust and debris, but the level of collection is dependent upon the performance of the vacuum to which it is connected, the speed of the air tool used, and the way in which a tool is handled by the user.

Do not assume that the Dust Collection Shroud is collecting 100% of the dust.

# SAFETY INSTRUCTIONS

Please refer to the Air Tool Manufacturer's Documentation for Safety, Operations, and Maintenance of all air tools in conjunction with Clayton Dust Collection Shrouds.

Carefully read all instructions before operating any Clayton Dust Collection Shroud.

Products offered by Clayton should not be modified, converted or otherwise altered from the original design without express written consent from Clayton Associates, Inc.

## Tool Intent

Clayton Dust Collection Shrouds are designed for use with a variety of air tools and provide dust collection during operations such as grinding, deburring, blending and polishing operations on materials such as metal, plastic, fiberglass, composites, rubber, glass and stone. Please refer to the air tool manufacturer's documentation for Tool Intent of all air tools used in conjunction with Clayton Dust Collection Shrouds.

**Do not use this tool for anything other than its intended applications.**

**This tool is not intended for use in potentially explosive atmospheres and is not insulated against contact with electrical power.**

**Clayton Dust Collection Shrouds are not designed to replace manufacturer installed safety guards and shields.**

**Never remove the factory installed safety devices from air tools used in conjunction with Clayton Dust Collection Shrouds.**

## Accessories

- Before mounting accessories, visually inspect for defects. Do not use defective accessories
- Follow tool specifications before choosing size and type of accessory

## WARNING

- Always wear eye protection. Operator of tool is responsible for following: eye, face, respiratory, hearing and body protection.

## CAUTION

- Hand, wrist and arm injury may result from repetitive work, motion and overexposure to vibration.
- Keep hand and clothing away from working end of the tool
- Be sure that any loose clothing, hair and all jewelry is properly restrained

## CAUTION

- Never exceed the RPM rating of the shroud or abrasive.
- Disconnect air hose from tool when changing abrasives, removing the shroud, or otherwise handling the working end of the tool

## CAUTION

**DO NOT USE** if tool vibration is excessive. Correct cause, and retest to ensure safe operation

- Make sure that work area is uncluttered, and others are at a safe range from the tools and debris
- Use a vise or clamping device to hold work piece firmly in place
- Do not apply excessive force on tool or apply "rough" treatment to it
- Potentially explosive atmospheres can be caused by dust and fumes resulting from sanding or grinding. Always use dust extraction or suppression systems which are suitable for the material being processed

## GETTING STARTED

### Hose Length

The vacuum hose included with the tool may be shortened to suit your particular needs. The hose can be easily cut to the desired length with a knife or hose cutting tools. Follow all safety instructions provided with cutting tools to prevent injury.

### Using the Shroud

- Hold the vacuum hose firmly when activating the tool to prevent the shroud from rotating
- If excessive vibration occurs, stop using the tool immediately, find, and correct the cause

### Replacing the Bushing

#### Slip Fixed Bushings

- Hold the shroud and rotate the bushing 1/4 turn counterclockwise to unlock from the shroud
- Remove the Bushing from the Shroud
- Drop a New Bushing into the Shroud
- Rotate 1/4 turn clockwise to lock the bushing into the shroud

#### Threaded Bushings

- Hold the shroud and unscrew the bushing by rotating counterclockwise
- Hold the shroud and screw in a new bushing by rotating clockwise until tight

## MAINTENANCE INSTRUCTIONS

### Important

A Preventative Maintenance Program is recommended whenever portable power tools are used.

### Routine Maintenance

- Use only genuine Clayton replacement parts to ensure quality
- Clean the tool with a damp cloth. Do not use petroleum based cleaners
- Replace damaged or worn components before use

## TROUBLE SHOOTING

### Excessive vibration is felt during tool use

- Bushing may be damaged – stop using tool immediately, identify cause and correct

### Excessive dust is evident during operation

- Clayton Dust Collection Shrouds reduce airborne (respirable) dust. You may see some larger debris not being collected that may require vacuuming at the end of grinding operations. This is normal
- Vacuum may be turned off, or vacuum filters may be clogged – check vacuum to ensure that it is operating properly, and that filters are clean
- Hose or shroud may be blocked – disconnect all hose fittings, and ensure that the pathway from shroud to vacuum port is clear

## ILLUSTRATED PARTS BREAKDOWN

### Clear Rev Slip Fixed Drill Guides

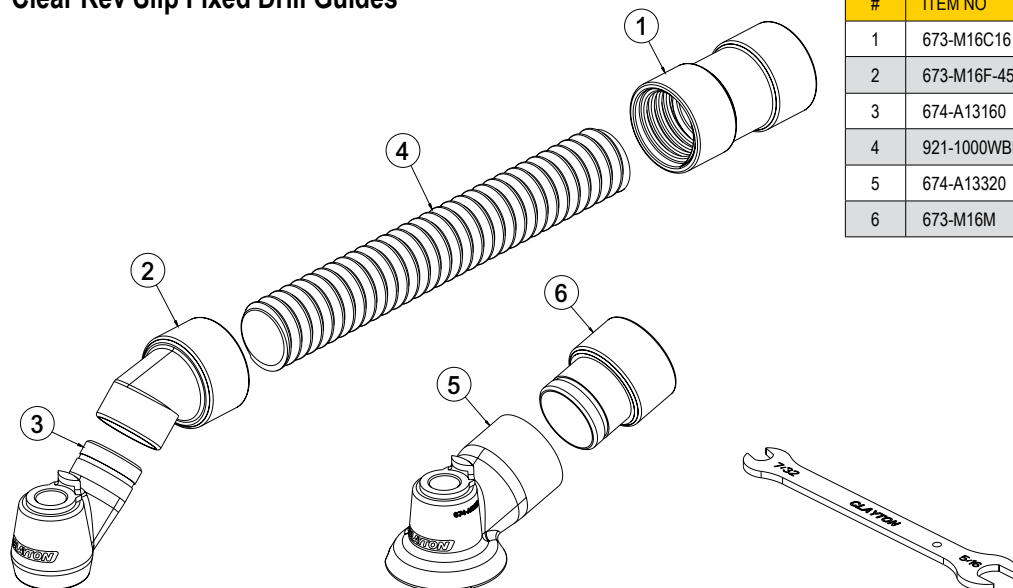

| # | ITEM NO       | DESCRIPTION                                  |
|---|---------------|--|
| 1 | 673-M16C16    | Swivel Coupler, 1" To 1" Hose                |
| 2 | 673-M16F-45   | 1" X 45 Deg Female Swivel                    |
| 3 | 674-A13160    | Clear Rev Drill Guide 1" SF Raw Shroud       |
| 4 | 921-1000WBKSC | 1" Vac Hose Wire Supported Static Conductive |
| 5 | 674-A13320    | Clear Rev Drill Guide 2" SF Raw Shroud       |
| 6 | 673-M16M      | Swivel Connector, 1" Male                    |

### Clear Rev Threaded Drill Guides 1/2-13

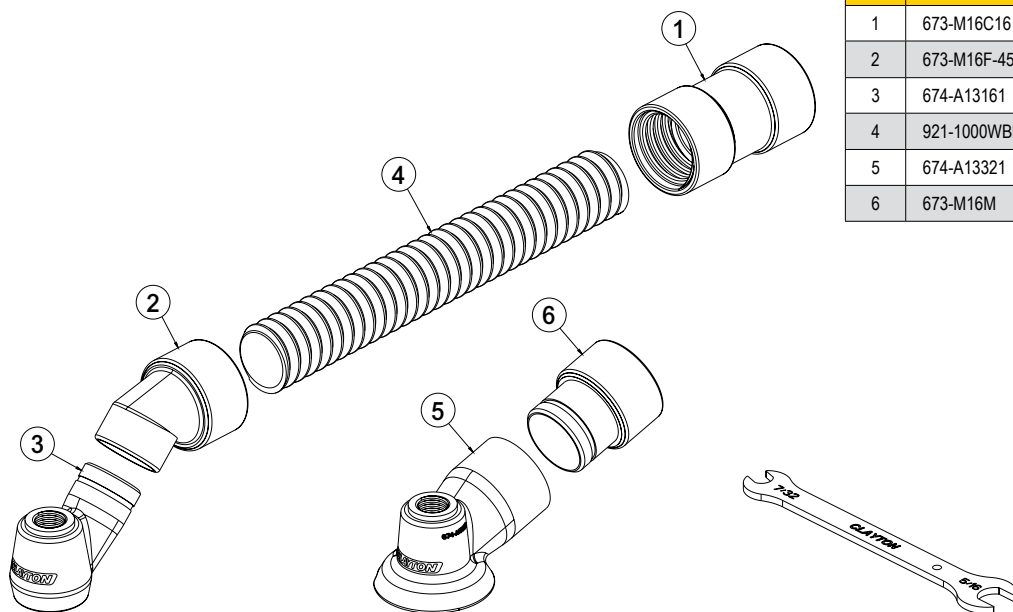

| # | ITEM NO       | DESCRIPTION                                  |
|---|---------------|--|
| 1 | 673-M16C16    | Swivel Coupler, 1" To 1" Hose                |
| 2 | 673-M16F-45   | 1" X 45 Deg Female Swivel                    |
| 3 | 674-A13161    | Clear Rev Drill Guide 1" Threaded Raw Shroud |
| 4 | 921-1000WBKSC | 1" Vac Hose Wire Supported Static Conductive |
| 5 | 674-A13321    | Clear Rev Drill Guide 2" Threaded Raw Shroud |
| 6 | 673-M16M      | Swivel Connector, 1" Male                    |

## ILLUSTRATED PARTS BREAKDOWN

### Clear Rev Threaded Drill Guides 3/4-16

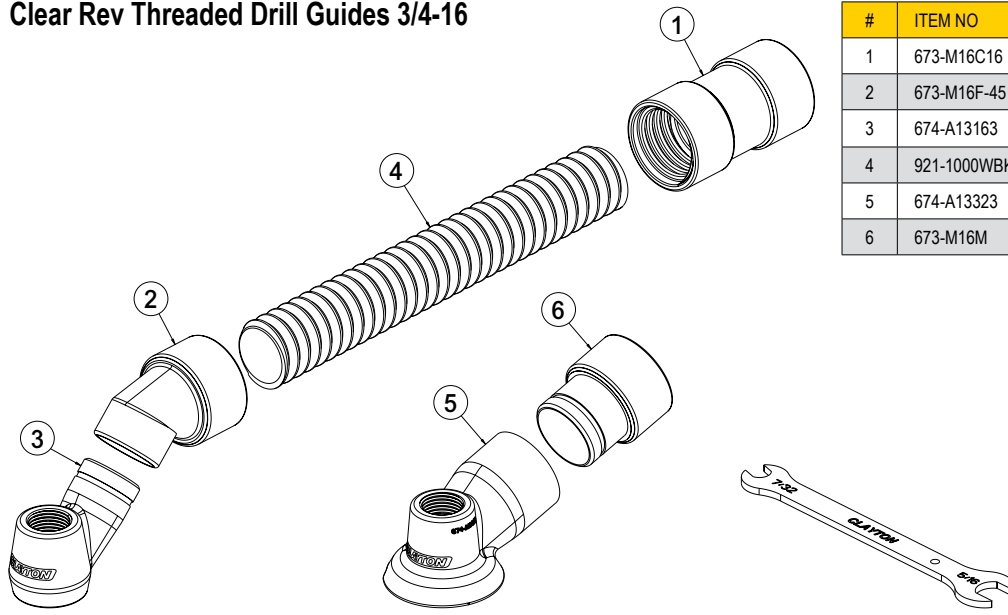

| # | ITEM NO       | DESCRIPTION                                    |
|---|---------------|--|
| 1 | 673-M16C16    | Swivel Coupler, 1" To 1" Hose                  |
| 2 | 673-M16F-45   | 1" X 45 Deg Female Swivel                      |
| 3 | 674-A13163    | Clear Rev Drill Guide 1" X 3/4" Tap Raw Shroud |
| 4 | 921-1000WBKSC | 1" Vac Hose Wire Supported Static Conductive   |
| 5 | 674-A13323    | Clear Rev Drill Guide 2" X 3/4" Tap Raw Shroud |
| 6 | 673-M16M      | Swivel Connector, 1" Male                      |

### Clear Rev Drill Shrouds 3/4in Open

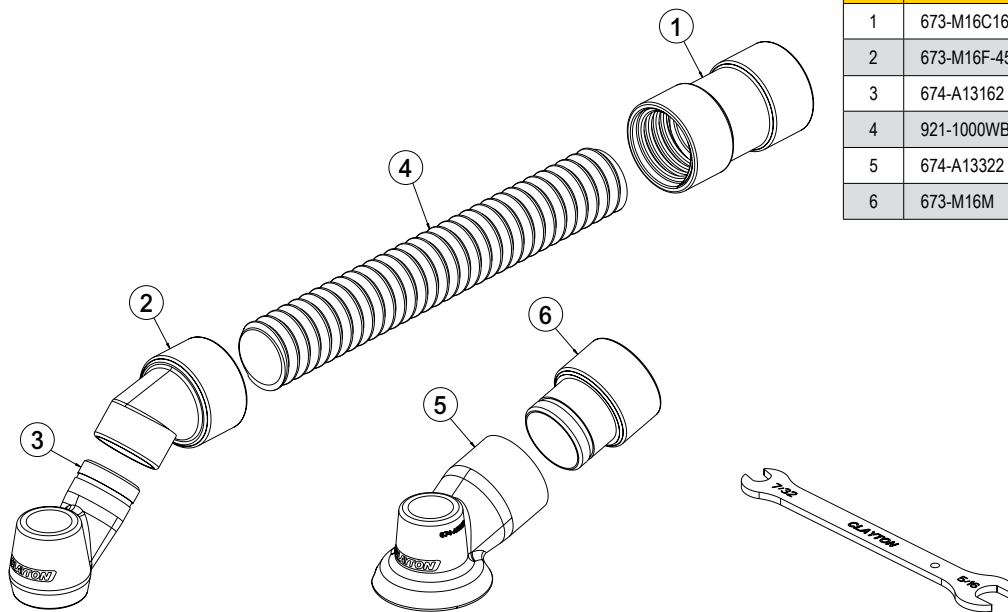

| # | ITEM NO       | DESCRIPTION                                  |
|---|---------------|--|
| 1 | 673-M16C16    | Swivel Coupler, 1" To 1" Hose                |
| 2 | 673-M16F-45   | 1" X 45 Deg Female Swivel                    |
| 3 | 674-A13162    | Clear Rev Drill Shroud 1" Raw Shroud         |
| 4 | 921-1000WBKSC | 1" Vac Hose Wire Supported Static Conductive |
| 5 | 674-A13322    | Clear Rev Drill Shroud 2" Raw Shroud         |
| 6 | 673-M16M      | Swivel Connector, 1" Male                    |

## LIMITED LIFETIME WARRANTY TERMS AND CONDITIONS

### Warranty Terms

Clayton Associates, Inc. guarantees its manufactured products against defects in materials or workmanship and will either repair or replace all parts that prove defective under normal use during the lifetime of the products. The warranty period shall commence from the date of paid invoice.

This warranty does not cover (a) repairs due to normal wear, accident, neglect, misuse, or use other than as indicated in the instruction booklet (b) products manufactured by third parties and distributed by Clayton (c) wear items such as bearings, rotor blades, regulators, valve stems, levers, shrouds, guards, O-rings, seals, gaskets, motor brushes, and other wearable parts.

### Repair within the Continental US

During the first 90 days of the warranty period, Clayton will provide parts and labor to the customer's site at no charge or pay freight costs associated with returning the products for repair to a Clayton selected service location and repair the product at no charge. Clayton personnel will determine the best way to repair the product.

Past 90 days, Clayton will provide parts to the customer's site at no charge or the customer may ship the product to a Clayton selected service location at customer's expense and Clayton will repair the product at no charge and provide return shipping.

### Repair Outside the Continental US

Clayton will provide parts to the customer's site at no charge or the customer may ship the product to a Clayton selected service location at customer's expense and Clayton will repair the product at no charge and provide return shipping.

### Limitation of Liability

Clayton shall not in any event be liable for any damages, loss of production time or profits, whether based on contract, warranty, negligence, strict liability or otherwise, including without limitation any consequential, incidental or special damages, arising with respect to the equipment or its failure to operate.

Clayton Associates, Inc. makes no other warranty or representation of any kind, except that of title, and all other warranties, express or implied, including warranties of merchantability or fitness for any particular purpose, are hereby expressly disclaimed.





**Clayton products are proudly made in the USA**

