

Safety – Operation – Maintenance

Keep this document in a safe place

Read and understand this manual before operating your air tool



Hand Sanding Blocks

Models with Prefix: 680-A275

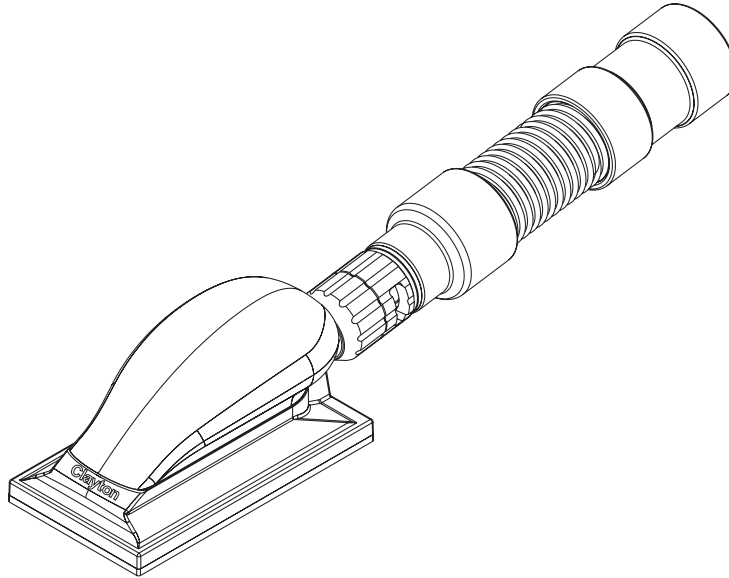

⚠ WARNING

Follow all safety rules for the protection of operating personnel as well as adjacent areas. Always operate, inspect and maintain this tool before use.

SAFETY LEGEND



⚠ WARNING

Read and understand operator's manual before using this equipment.



⚠ WARNING

Eye protection is required when operating this equipment.



⚠ WARNING

Hearing protection is required when applicable PEL (permissible exposure limit) is exceeded.



⚠ WARNING

Respiratory protection is required when applicable PEL (permissible exposure limit) is exceeded.

⚠ WARNING

Some dust created by sanding, grinding, drilling, and other construction activities contain chemicals known to cause cancer, birth defects or other reproductive harm. Some examples of these chemicals are:

- Lead from lead-based paints
- Crystalline silica from bricks and cement and other masonry products
- Chromium and other heavy metals from paint and primers

Your risk from these exposures varies, depending on how often you do this type of work. To reduce your exposure to these chemicals: work in a well ventilated area, and work with approved safety equipment, such as dust masks that are specially designed to filter out microscopic particles.

Clayton Vacuum Assisted Sanding Blocks aid in the collection of airborne dust and debris, but the level of collection is dependent upon the performance of the vacuum to which it is connected, and the way in which a tool is handled by the user.

Do not assume that the Vacuum Assisted Sanding Block is collecting 100% of the dust.

Carefully read all instructions before operating any Clayton Vacuum Assisted Sanding Blocks. Products offered by Clayton should not be modified, converted or otherwise altered from the original design without express written consent from Clayton Associates, Inc.

Tool Intent

Clayton Vacuum Assisted Sanding Blocks are designed for dust collection during grinding, deburring, blending and polishing operations on metal, plastic, fiberglass, composites, rubber, glass and stone.

Do not use this tool for anything other than its intended applications.

This tool is not intended for use in potentially explosive atmospheres and is not insulated against contact with electrical power.

Collection Efficiency

Clayton Vacuum Assisted Sanding Blocks are very effective in limiting worker exposure to airborne dust and debris. The level of collection is dependent upon the performance of the vacuum to which it is connected and the way in which a tool is handled by the user. Do not assume that the Vacuum Assisted Sanding Block is collecting 100% of the dust.

Training

It is the tool owner's responsibility to train all operators in the safe use of this tool and its accessories.

Accessories

- Before mounting accessories, visually inspect for defects. Do not use defective accessories.
- Follow tool specifications before choosing size and type of accessory

WARNING

Always wear eye protection. Operator of tool is responsible for following: eye, face, respiratory, hearing and body protection.

CAUTION

Hand, wrist and arm injury may result from repetitive work, motion and overexposure to vibration.

- Keep hand and clothing away from working end of the tool
- Be sure that any loose clothing, hair and all jewelry is properly restrained
- Make sure that work area is uncluttered, and others are at a safe range from the tools and debris
- Use a vise or clamping device to hold work piece firmly in place
- Do not apply excessive force on tool or apply "rough" treatment to it
- Potentially explosive atmospheres can be caused by dust and fumes resulting from sanding or grinding. Always use dust extraction or suppression systems which are suitable for the material being processed
- Use only the proper size and style abrasive for the Vacuum Assisted Sanding Blocks

Hose Length

The vacuum hose included with the tool may be shortened to suit your particular needs. The hose can be easily cut to the desired length with a knife or hose cutting tools. Follow all safety instructions provided with cutting tools to prevent injury.

Connecting the Sanding Block

Always disconnect the tool from power before connecting or disconnecting the Dust Collection Shroud from any tool.

- Connect the sander to a vacuum source
- Adjust the vacuum relief valve to allow free movement of the sander on the work surface.

Attaching Abrasives

Vacuum Assisted Sanding Blocks use Hook & Loop Abrasive.

- Align the abrasive and press firmly to engage the hooks and loops.

Important

A Preventative Maintenance Program is recommended whenever portable power tools are used.

Routine Maintenance

- Use only genuine Clayton replacement parts to ensure quality
- Clean the tool with a damp cloth. Do not use petroleum based cleaners
- Visually inspect Vacuum Assisted Sanding Blocks and abrasives for frays, visible damage and signs of deterioration. Replace damaged or worn components before use

Handling and Storage

- Use of tool rests, hangers and/or balancers is recommended
- Protect abrasive from exposure to water, solvents, high humidity, freezing temperature and extreme temperature changes
- Store Vacuum Assisted Sanding Blocks in protective racks or compartments to prevent damage

Warranty & Repair

This tool is covered by a 1 year manufacturer's warranty. Wear items such as pads are not covered.

Excessive dust is evident during operation

- Try to keep the abrasive as flat to the work surface as possible
- Clayton Vacuum Assisted Sanding Blocks reduce airborne (respirable) dust. You may see some larger debris not being collected that may require vacuuming at the end of sanding operations. This is normal
- Vacuum may be turned off, or vacuum filters may be clogged – check vacuum to ensure that it is operating properly, and that filters are clean
- Hose or shroud may be blocked – disconnect all hose fittings, and ensure that the pathway from shroud to vacuum port is clear
- Abrasive grit may be too coarse. On softer materials, coarse abrasives may generate overwhelming amounts of dust – switch to a finer grit abrasive

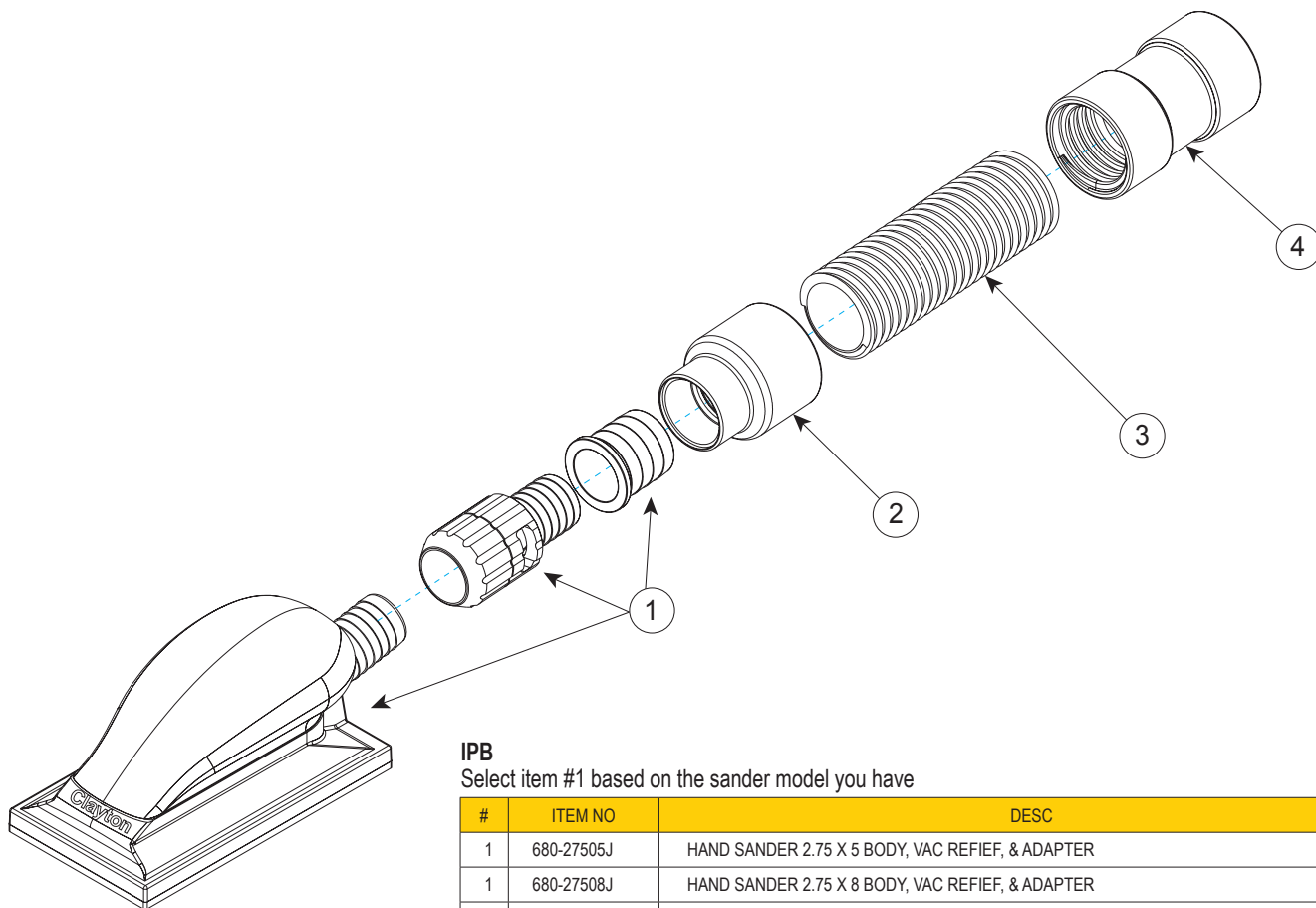
**IPB**

Select item #1 based on the sander model you have

#	ITEM NO	DESC
1	680-27505J	HAND SANDER 2.75 X 5 BODY, VAC REFIEF, & ADAPTER
1	680-27508J	HAND SANDER 2.75 X 8 BODY, VAC REFIEF, & ADAPTER
1	680-27516J	HAND SANDER 2.75 X 16 BODY, VAC REFIEF, & ADAPTER
1	680-275F16J	HAND SANDER 16IN FLEXIBLE BODY, VAC REFIEF, & ADAPTER
1	680-275R16J	HAND SANDER 16IN RIGID BODY, VAC REFIEF, & ADAPTER
1	680-27505CK	HAND SANDER 2.75 X 5 CURVED SHAPES KIT BODY, VAC REFIEF, & ADAPTER
1	680-27508CK	HAND SANDER 2.75 X 8 CURVED SHAPES KIT BODY, VAC REFIEF, & ADAPTER
1	680-27505DK	HAND SANDER 2.75 X 5 DISC CURVED SHAPES KIT BODY, VAC REFIEF, & ADAPTER
2	673-B0054T	HOSE ADAPTER 1IN FHT X 3/4 FNPT
3	674-3004-01	VAC HOSE 1IN X 2FT
4	673-M16C16	1IN X 1IN SWIVEL

ABRASIVES

The following Clayton screen abrasives are recommended for maximum dust collection. Additional grits and minerals are available.

2-3/4 X 5in Screen Abrasive

MODEL	GRIT	SHEETS
805-P80	80	50
805-P120	120	50
805-P180	180	50
805-P240	240	50
805-P320	320	50
805-P400	400	50

2-3/4 x 8in Screen Abrasive

MODEL	GRIT	SHEETS
808-P80	80	50
808-P120	120	50
808-P180	180	50
808-P240	240	50
808-P320	320	50
808-P400	400	50

2-3/4 x 16in Screen Abrasive

MODEL	GRIT	SHEETS
816-P80	80	50
816-P120	120	50
816-P180	180	50
816-P240	240	50
816-P320	320	50
816-P400	400	50