

Safety – Operation – Maintenance

Keep this document in a safe place

Read and understand this manual before operating your air tool



HEPA Grinding Station

High-Flow HEPA Filtration System

Models with Prefix: GS-1350

Designed for the collection of sanding and grinding dust.



Scan this QR code for
online instructions and
documentation, or visit
www.ClaytonHowTo.com

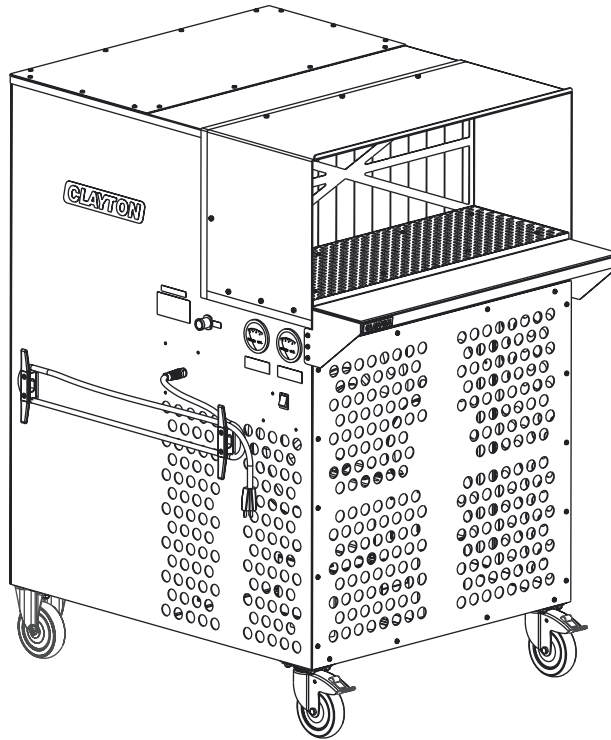

⚠ WARNING

SAFETY LEGEND



⚠ WARNING

Read and understand operator's manual before using this equipment.



⚠ WARNING

Eye protection is required when operating this equipment.



⚠ WARNING

Hearing protect is recommended when operating this equipment.



⚠ WARNING

Respiratory protection is recommended operating this equipment.

⚠ WARNING

- The proper HEPA and Panel Filters from Clayton Associates must be installed in the GS-1350 at all times.
- The GS-1350 must be used with the supplied or recommended accessories from Clayton Associates.
- Any alteration to the GS-1350 by a third party will nullify its warranty.
- Always lock the brakes on the GS-1350 once positioned so that it does not roll.

TABLE OF CONTENTS

Table Of Contents.....	2
Important Safety Instructions.....	3
Applications & Environments.....	4
What's Included.....	4
Specifications & Requirements.....	5
Getting Started.....	5
Before Each Use.....	7
Panel Filter Replacement.....	8
HEPA Filter Replacement.....	9
Routine Maintenance.....	12
Illustrated Parts Breakdown.....	13
Limited Lifetime Warranty Terms And Conditions.....	19

READ ALL INSTRUCTIONS BEFORE USING THIS APPLIANCE

WARNING

- **Do not** leave appliance when plugged in. Unplug from outlet when not in use and before servicing.
- This unit is to be used only indoors and in a dry location.
- Use only as described in this manual. Use only manufacturer's recommended attachments.
- **Do not** use with damaged cord or plug. If appliance is not working as it should, has been dropped, damaged, left outdoors, or dropped into water, return it to a service center.
- Handle provided on power head is used only for removal of power head during maintenance.
- Before separation of power head from tank, users must disengage draw latches on tank.
- **Do not** pull or carry by cord, use cord as a handle, close a door on cord, or pull cord around sharp edges or corners.
- **Do not** run appliance over cord. Keep cord away from heated surfaces.
- **Do not** unplug by pulling on cord. To unplug, grasp the plug, not the cord.
- **Do not** handle plug or appliance with wet hands.
- **Do not** put any object into openings. **Do not** use with any opening blocked; keep free of dust, lint, hair, and anything that may reduce air flow.
- Keep hair, loose clothing, fingers, and all parts of body away from openings and moving parts.
- Turn off all controls before unplugging.
- **Do not** use to pick up flammable or combustible liquids, such as gasoline, or use in areas where they may be present.
- Connect to a properly grounded outlet only. Refer to "EARTHING/GROUNDING INSTRUCTIONS" on page 3.
- **Do not** pick up anything that is burning or smoking, such as cigarettes, matches, or hot ashes.
- **Do not** use without all filters in place.
- **Do not** allow to be used as a toy. Close attention necessary when used by or near children.

EARTHING/GROUNDING INSTRUCTIONS

WARNING – Improper connection of the equipment-earthing/grounding conductor can result in a risk of electric shock. Check with a qualified electrician or service person if you are in doubt as to whether the outlet is properly earthed/grounded. Do not modify the plug provided with the appliance – if it will not fit the outlet, have a proper outlet installed by a qualified electrician.

- **USA 120V**
This appliance has a earthing/grounding attachment plug that looks like the plug illustrated in Figure 1. Make sure that the appliance is connected to an outlet having the same configuration as the plug. No adapter should be used with this appliance.



APPLICATIONS & ENVIRONMENTS

- Designed for general and hazardous dust.
- Dry recovery only.

⚠ WARNING

Do not use this equipment to collect combustible dust.

WHAT'S INCLUDED

- GS-1350 Grinding Station

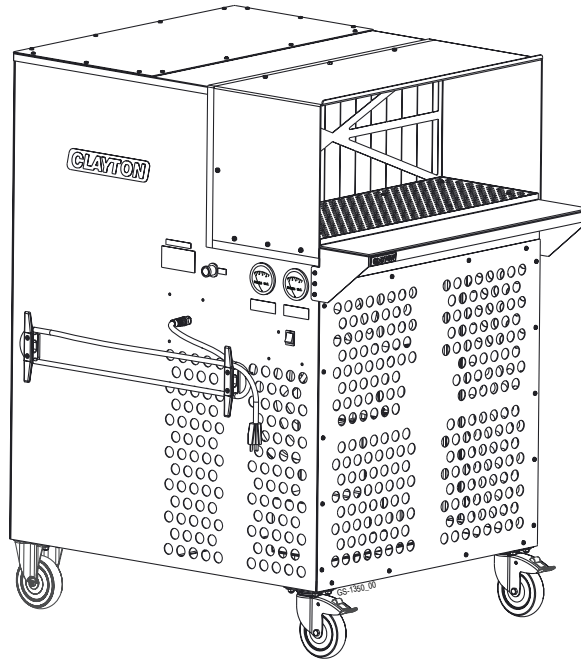

Consumables

Use only the following Clayton consumables:

- 627-1350PM08 – Panel Filter 30 in x 13 in MERV 8;
- 627-1350PM13 – Panel Filter 30 in x 13 in MERV 13;
- 627-1350H – HEPA Filter 14 in x 30 in (2 required).

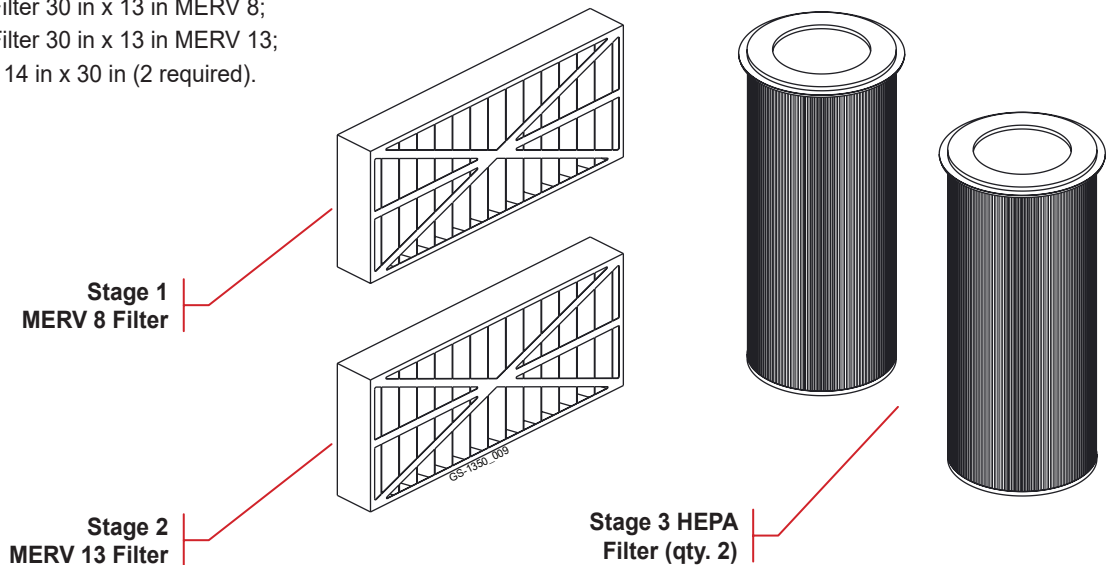

SPECIFICATIONS & REQUIREMENTS

Weight	<i>TBD</i> lbs (<i>TBD</i> kg)
Dimensions (W x D x H)	30.70 x 43.00 x 51.66 in (77.98 x 109.22 x 131.22 cm)
HEPA Filter Efficiency	99.995% @ 0.3 µm (H14)
Panel Filter Efficiency	MERV 8 @ 10 micron
Panel Filter Efficiency	MERV 13 @ 0.3 micron
Sounds Pressure Level	<70 dBA
Power Consumption	120VAC~ 13.5A
Flow	1300 CFM (204 SCMH)
Vacuum Suction.....	120 in/H ₂ O (30 kPa)

GETTING STARTED

1. Using a forklift, carefully remove the Grinding Station from the shipping pallet.

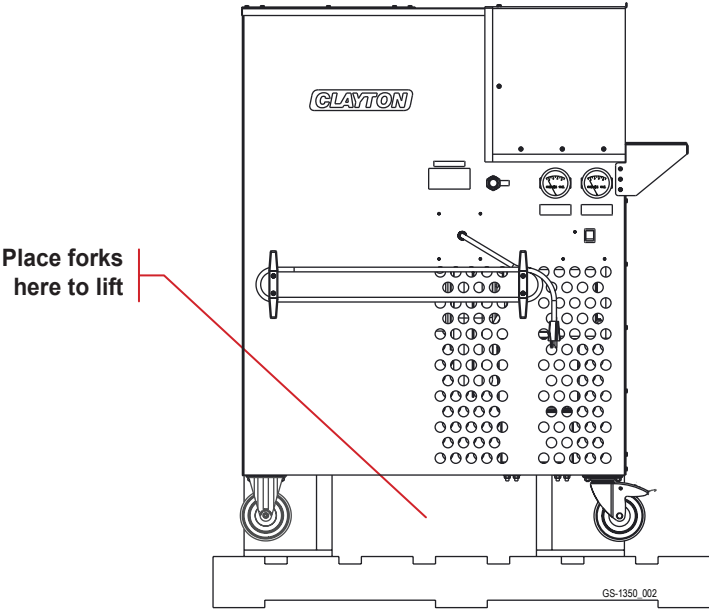

2. Visually inspect the Grinding Station to ensure that no parts are missing or damaged.

GETTING STARTED

3. Familiarize yourself with the Grinding Station.

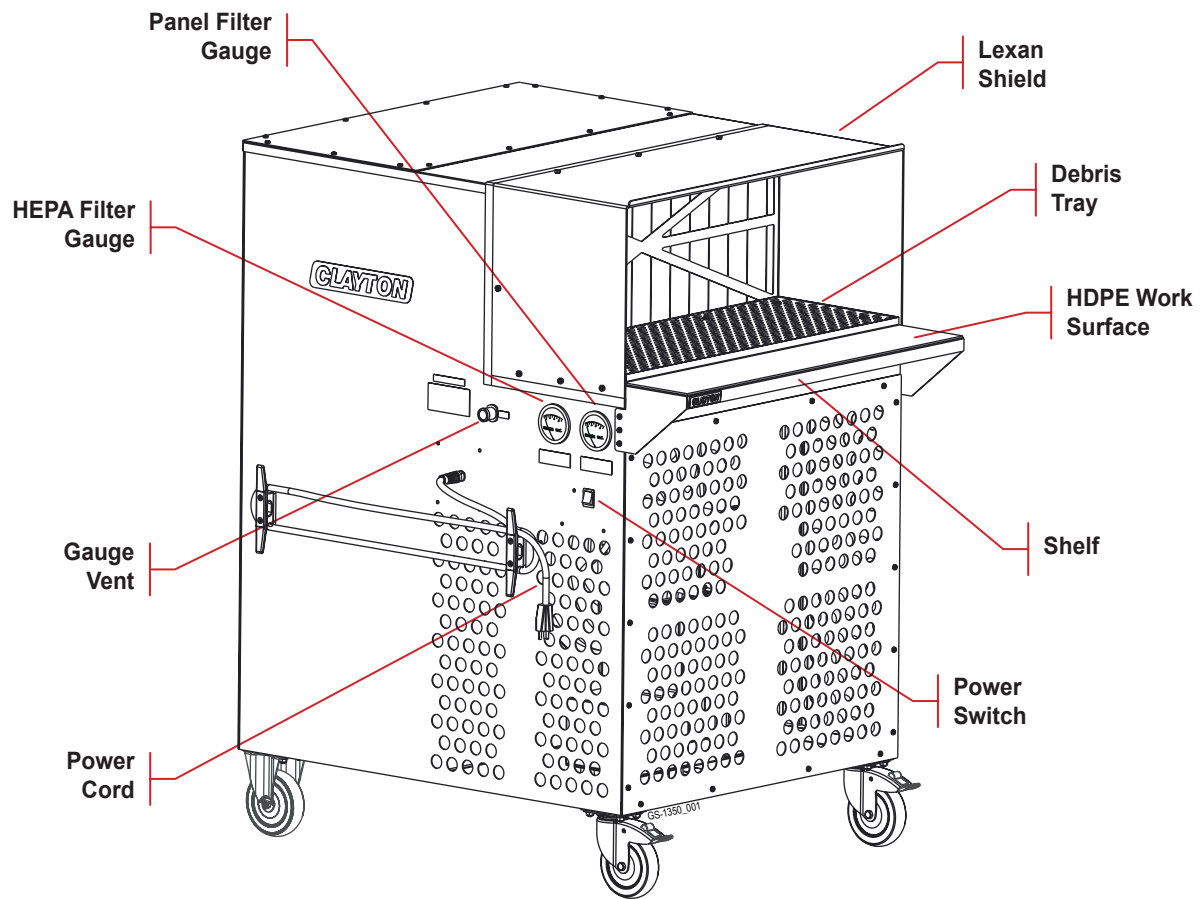

GETTING STARTED

4. The Grinding Station requires a DEDICATED 120VAC, 20A circuit equipped with NEMA 5-20R receptacles.

- Do not attempt to plug the Grinding Station into a standard 15A receptacle.

⚠ CAUTION: You must wait 60 seconds after shutdown before restart.
Failure to wait 60 seconds may trip electrical breaker.

NEMA 5-20
Receptacles

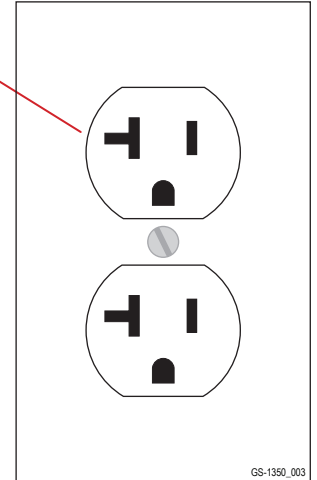

5. Always keep the Gauge Vent clear.

6. Cleaning the Lexan Shield

- Only use a mild soap/detergent, lukewarm water, and a clean sponge or a soft cloth.
- Never use ammonia, vinegar, alcohol, or similar cleaners.

7. The following customer-provided tools and items are required to perform other routine maintenance procedures:

- T25 TORX® Driver;
- Anti-seize compound.

BEFORE EACH USE

Prepare the Grinding Station for Use

- Verify the power switch on the Grinding Station is in the OFF position before proceeding.
- Always engage the two (2) front wheel brakes to prevent the Grinding Station from rolling.

1. Unwind the power cord (stored on the side of the chassis) and insert the plug into an appropriate power source.

2. Check the Filters.

- Turn the Grinding Station power switch to the ON position.
- Wait 10 seconds for the blower to stabilize.
- If the Panel Filter Gauge exceeds 0.8 refer to "Replace the Panel Filters" on page 8.
- If the HEPA Filter Gauge exceeds 1.0 refer to "Replace the HEPA Cartridge Filters" on page 9.

PANEL FILTER REPLACEMENT

Replace the Panel Filters

- If the Panel Filter Gauge exceeds 0.8, replace the Panel Filters, one at a time, starting with the Stage 1 Filter.

1. Safe the Grinding Station

- Deactivate the Grinding Station.
- Disconnect the Grinding Station from the power source.

2. Remove the Debris Tray.

- Slide the Debris Tray out and set aside.

3. Remove the HDPE Work Surface

- Slide the HDPE Work Surface out and set aside.

4. Remove the Stage 1 MERV 8 Panel Filter.

- Grasp the filter pleats and carefully slide the Stage 1 Filter out and set aside.

5. Install a new Stage 1 MERV 8 Filter.

- Slide a new Stage 1 Filter in until it is flush with the Stage 2 Filter.

6. Test the Panel Filters.

- Connect the Grinding Station to an appropriate power source.
- Activate the Grinding Station.
- Wait 10 seconds for the blower to stabilize.
- Check the Panel Filter Gauge. If it exceeds 0.8, repeat the above procedure to replace the Stage 2 MERV 13 Filter.

7. Insert the HDPE Work Surface.

- Slide the HDPE Work Surface into the chamber.

8. Insert the Debris Tray.

- Slide the Debris Tray into the chamber.

9. Return the Grinding Station to service.

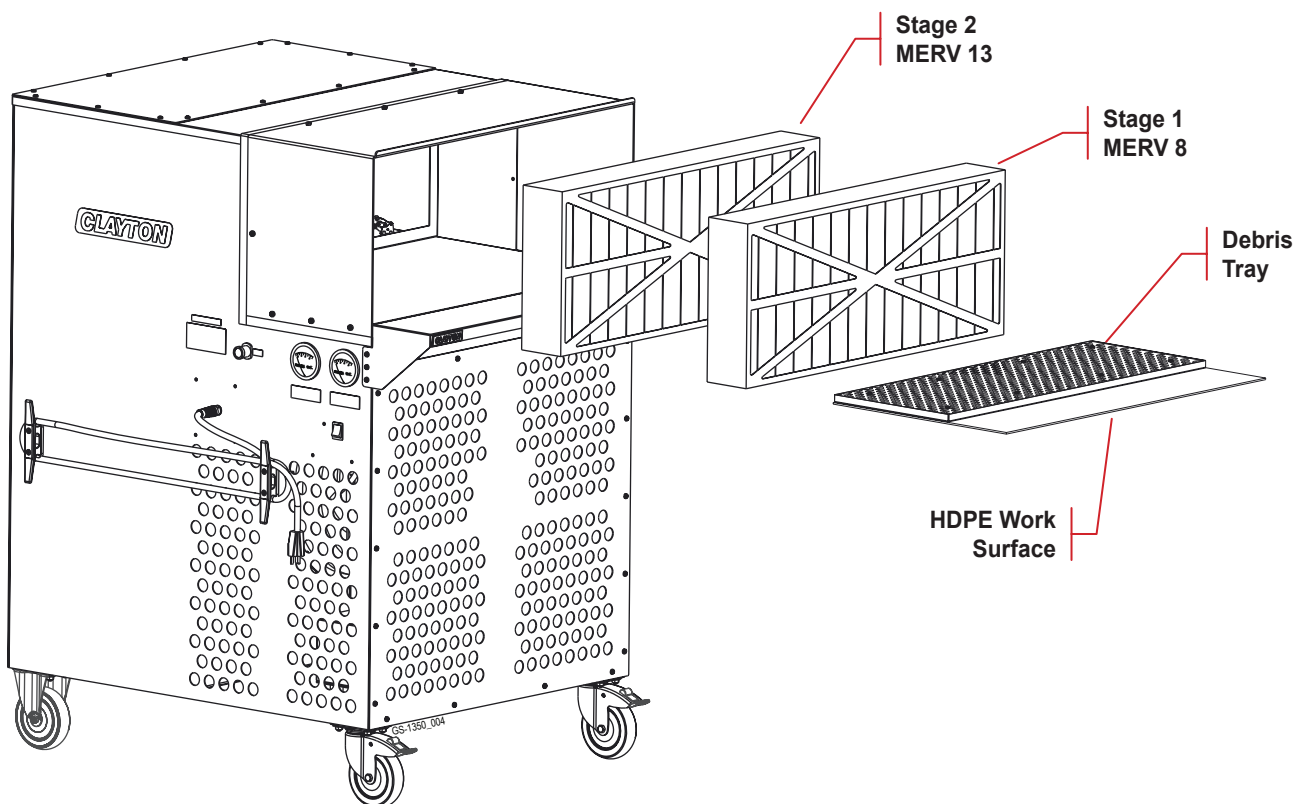

HEPA FILTER REPLACEMENT

Replace the HEPA Cartridge Filters

- If the HEPA Filter Gauge exceeds 1.0 replace the two Stage 3 HEPA Cartridge Filters.

1. Safe the Grinding Station.

- Deactivate the Grinding Station.
- Disconnect the Grinding Station from the power source.

2. Remove the HEPA Filter Compartment Cover.

- Use a T25 TORX driver to remove the fourteen (14) 10-32 x 3/8" TORX screws securing the HEPA Filter Compartment Cover to the chassis.
- Remove the cover and set aside.

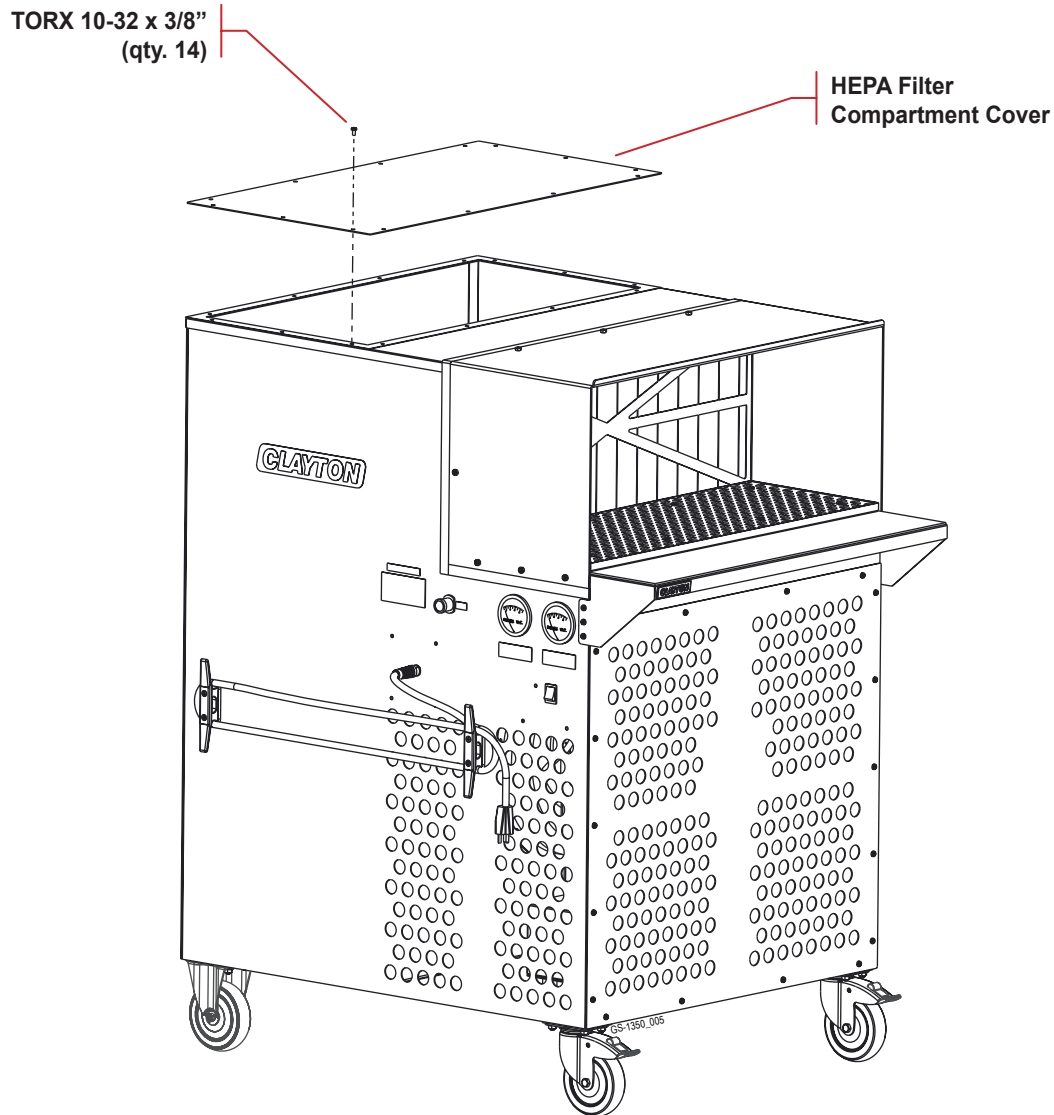

HEPA FILTER REPLACEMENT

3. Disengage eight (8) Toggle Latches to release the two (2) HEPA Filters.

- The HEPA Filter are accessed via the top of the Grinding Station.
- Lift the red handle on each toggle latch to disengage the latch.

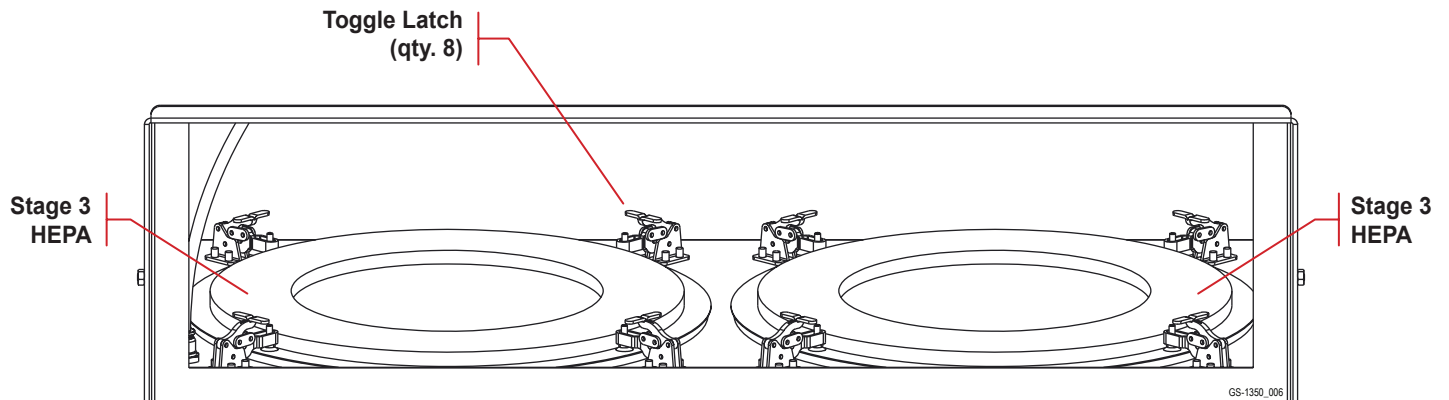

Front View [Partial] of Grinding Station Showing 8 Toggle Latches Securing Stage 3 HEPA Filters

4. Remove the two (2) HEPA Filters from the Filter Compartment.

- Carefully lift each cartridge up and out of the Filter Compartment.

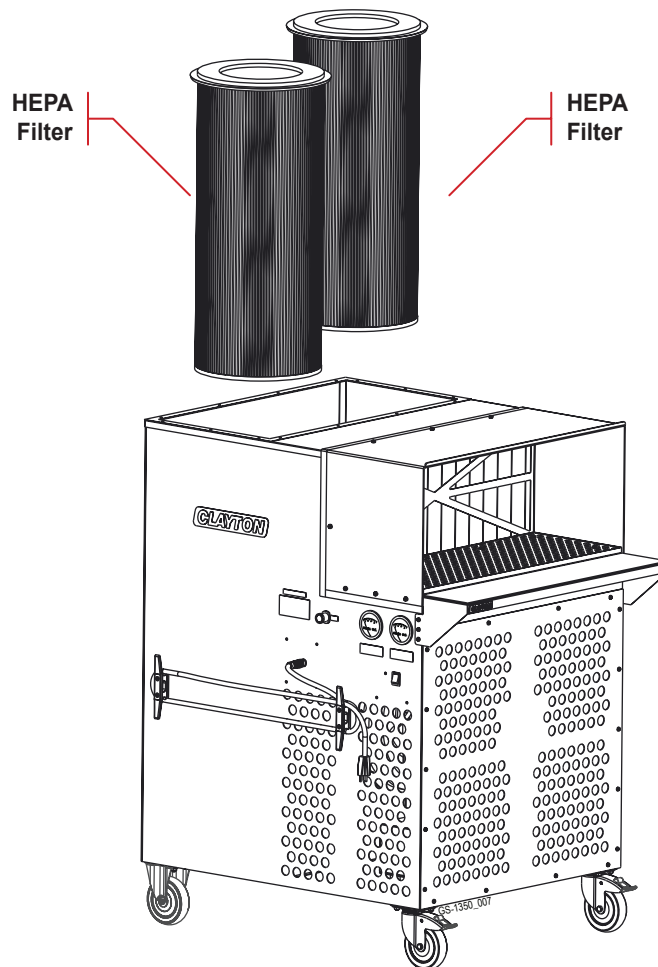

HEPA FILTER REPLACEMENT

5. Install two (2) new HEPA Filters.

- Carefully slide each cartridge into the HEPA Filter Compartment until firmly seated.
- When properly seated, engage each of the eight (8) Toggle Latches by pressing down/lifting up the red handle.

6. Replace the HEPA Filter Compartment Cover.

- Position the HEPA Filter Compartment Cover on the chassis, lining up all mounting holes.
- Apply a small amount of anti-seize compound to each screw before inserting into the HEPA Filter compartment cover.
- Use the T25 TORX driver to secure the cover to the chassis using the fourteen (14) 10-32 x 3/8" TORX screws removed in Step 1.

7. Test the HEPA Filters.

- Connect the Grinding Station to an appropriate power source.
- Activate the Grinding Station.
- Wait 10 seconds for the blower to stabilize.
- Check the HEPA Filters Gauge.

8. Return the Grinding Station to service.

ROUTINE MAINTENANCE

Clean/Empty the Large Debris Tray:

1. **Remove the Debris Tray.**
 - Slide the Debris Tray out.
2. **Remove the Mesh insert.**
 - Use the T25 TORX driver to remove the eight (8) 10-32 x 3/8" TORX screws securing the mesh insert to the tray.
3. **Clean the Mesh Insert.**
4. **Empty the tray of any debris.**
5. **Clean the mesh insert and/or the tray as needed.**
 - Replace tray and/or mesh insert as required.
6. **Insert mesh into the tray.**
 - Verify mounting holes line up.
 - Use the T25 TORX driver to secure the mesh insert to the tray using eight (8) 10-32 x 3/8" TORX screws.
7. **Insert the Debris Tray.**
 - Slide the Debris Tray into the chamber.

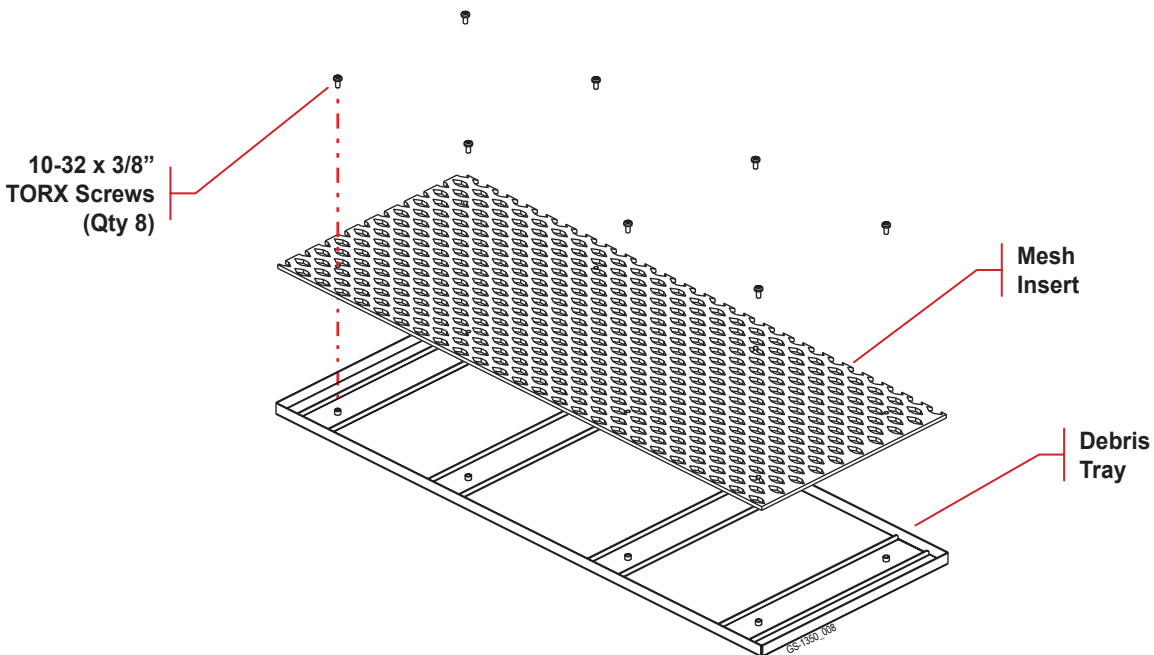

Remove/Replace HDPE Work Surface

1. **Remove Debris Tray.**
 - Slide the Debris Tray out.
2. **Remove the HDPE Work Surface.**
 - Slide the HDPE Work Surface out.
3. **Examine the HDPE Work Surface.**
 - Wipe down and/or use isopropyl alcohol to clean the Work Surface. Replace the Work Surface with a new item if it is worn/damaged.
4. **Insert the HDPE Work Surface.**
 - Slide the HDPE Work Surface into the chamber.
5. **Insert the Debris Tray.**
 - Slide the Debris Tray into the chamber.

ILLUSTRATED PARTS BREAKDOWN

GS-1350

SEQ	ITEM NO	DESCRIPTION
1	602-2004	HDPE 17.75 X 30.7 X 1/8 FOR GRINDING STATION
2	610-202I	GRINDING STATION 1350 TRAY
3	610-202J	GRINDING STATION 1350 TRAY MESH
4	610-202K	GRINDING STATION 1350 WORK SURF EXT
5	985-009	LABEL, CLAYTON LOGO, DOMED 1.5 X 3
6	SE103206-XPSM-Z	SCREW 10-32 X 3/8IN SS TORX

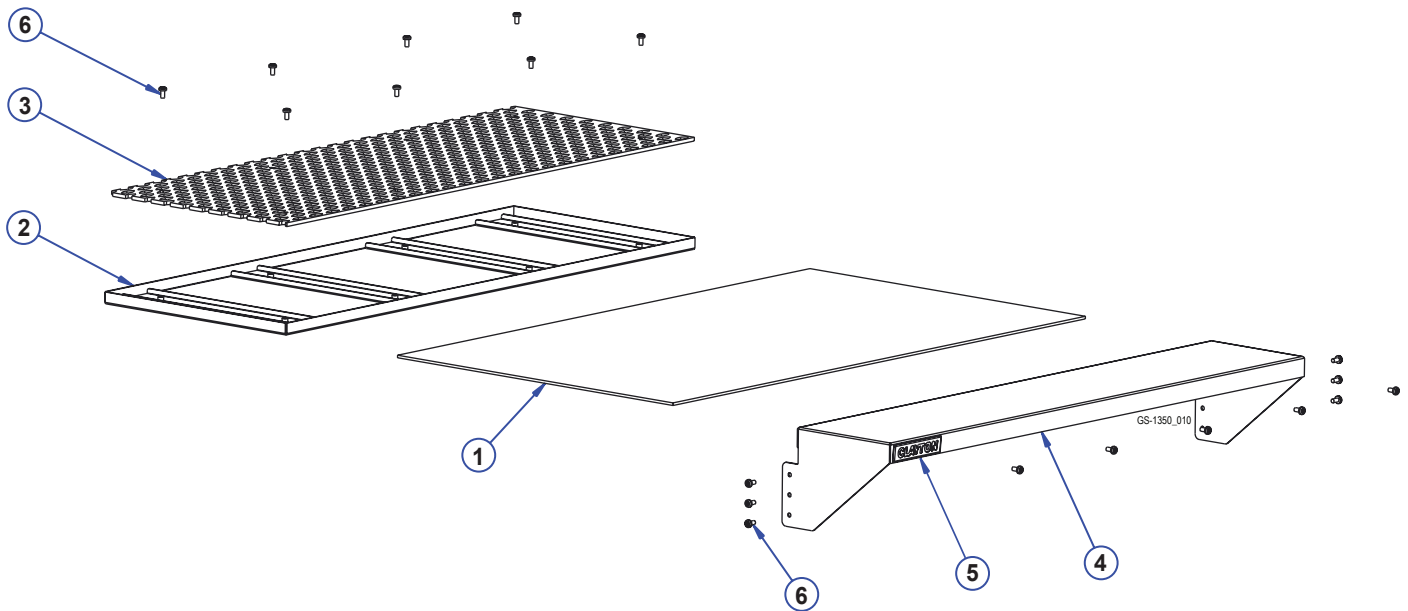

ILLUSTRATED PARTS BREAKDOWN

GS-1350

SEQ	ITEM NO	DESCRIPTION
1	610-202C	GRINDING STATION 1350 COVER
2	610-202G	LEXAN SHIELD FOR 1350 GRINDING STATION
3	NE10320608-HNSZ	NUT 10-32 NYLON LOCK SS SHORT
4	SE103206-XPSM-Z	SCREW 10-32 X 3/8IN SS TORX

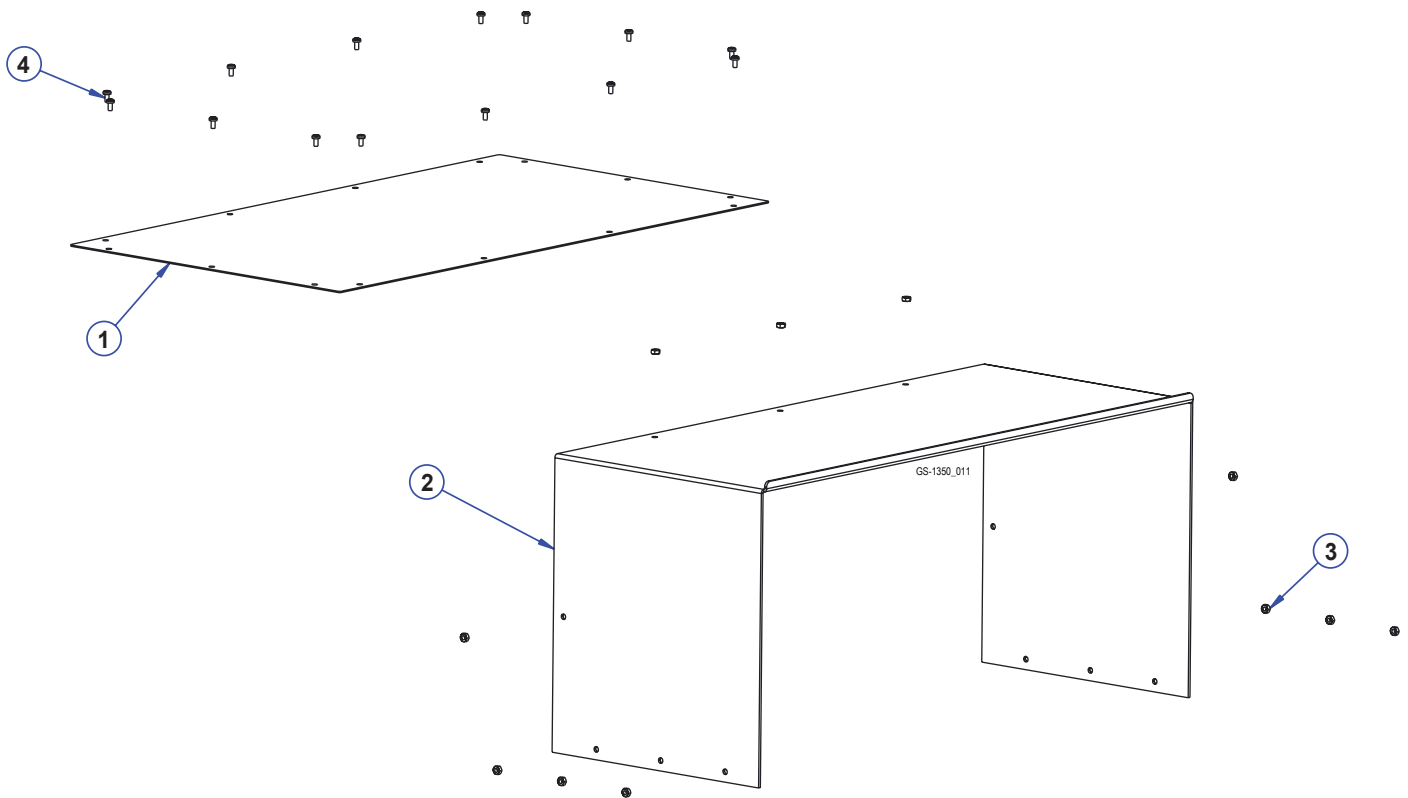

ILLUSTRATED PARTS BREAKDOWN

GS-1350

SEQ	ITEM NO	DESCRIPTION
1	701-05-001SL	CASTER 5IN SWIVEL LOCKING
2	701-05-001R	CASTER FIXED 5IN NON-LOCKING
3	610-202D	GRINDING STATION 1350 DOOR
4	650-013	CLEAT BLACK NYLON
5	NE12241420-HNSZ	NUT 12-24 NYLON LOCK SS
6	NE20180815-HNSZ	NUT,NYLON LOCK 5/16-18 HEX JAM SS
7	SE103206-XPSM-Z	SCREW 10-32 X 3/8IN SS TORX
8	SE122432-PFSM-Z	SCREW 12-24 X 2IN FLAT HEAD PHILLIPS SS
9	WE204804-RFS-Z	WASHER .313ID X .750OD .063H ROUND STAINLESS

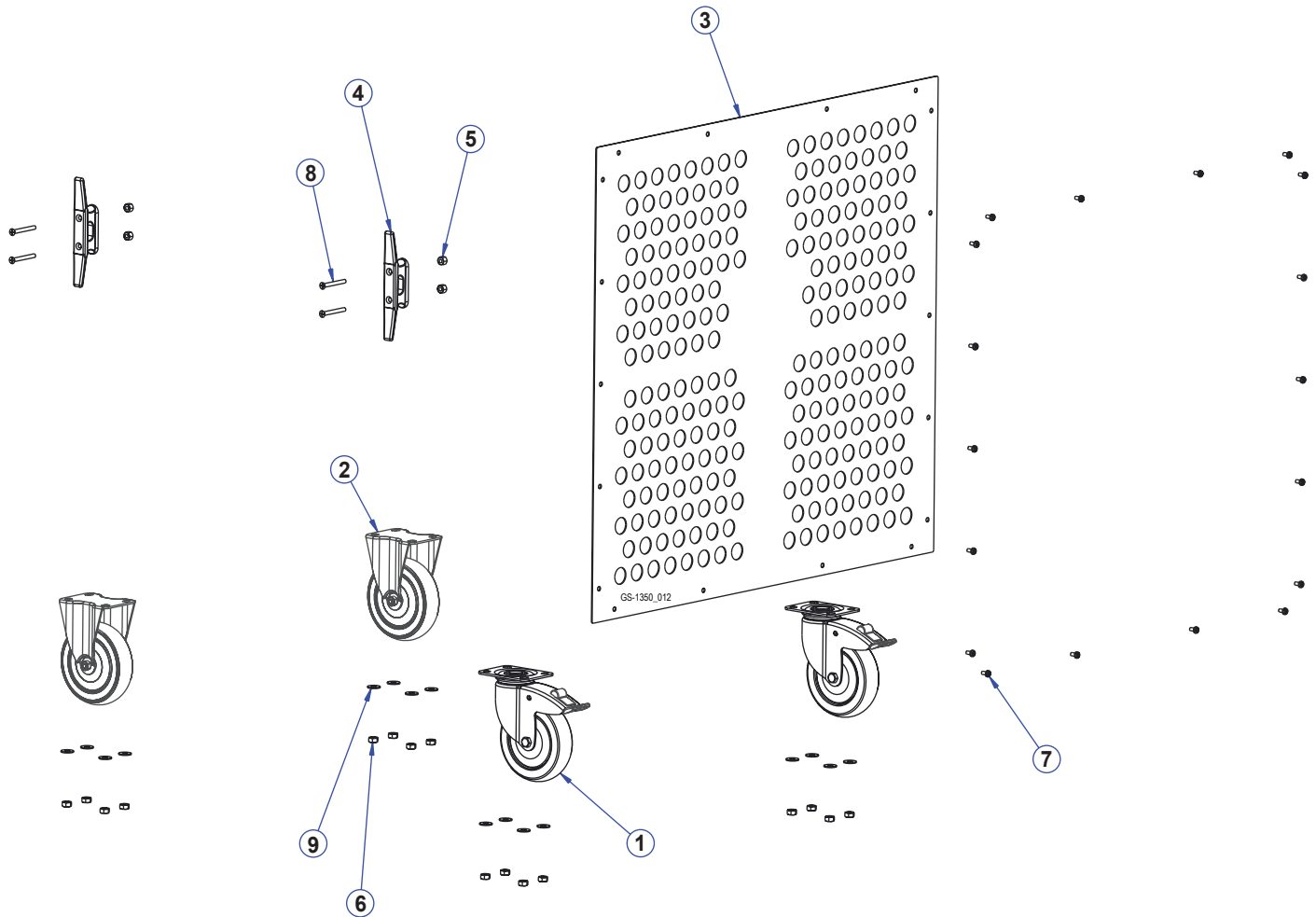

ILLUSTRATED PARTS BREAKDOWN

GS-1350

SEQ	ITEM NO	DESCRIPTION
1	150-032	OUTLET, WALL MOUNT NEMA 5-20R SINGLE, SCREW ON TERMINALS
2	150-032B	OUTLET COVER, WALL MOUNT NEMA 5-20R SINGLE ROUND OUTLET
3	350-023	STRAIN RELIEF FOR 20 AMP CORD
4	610-202E	GRINDING STATION 1350 ELEC BOX
5	900-014	JUMPER WIRE, GROUNDING W RING TERM
6	900-018	FLAG QUICK DISCONNECT TERM .250 X .032 14-16 AWG
7	900-023	SWITCH 20 AMP LIGHTED
8	900-143N520P-30	CORD 14/3 20A PLUG 30FT YEL
9	900-WAG-221-412	WAGO 2 WIRE CONNECTOR
10	900-WAG-221-413	WAGO 3 WIRE CONNECTOR
11	NE10320608-HNSZ	NUT 10-32 NYLON LOCK SS SHORT

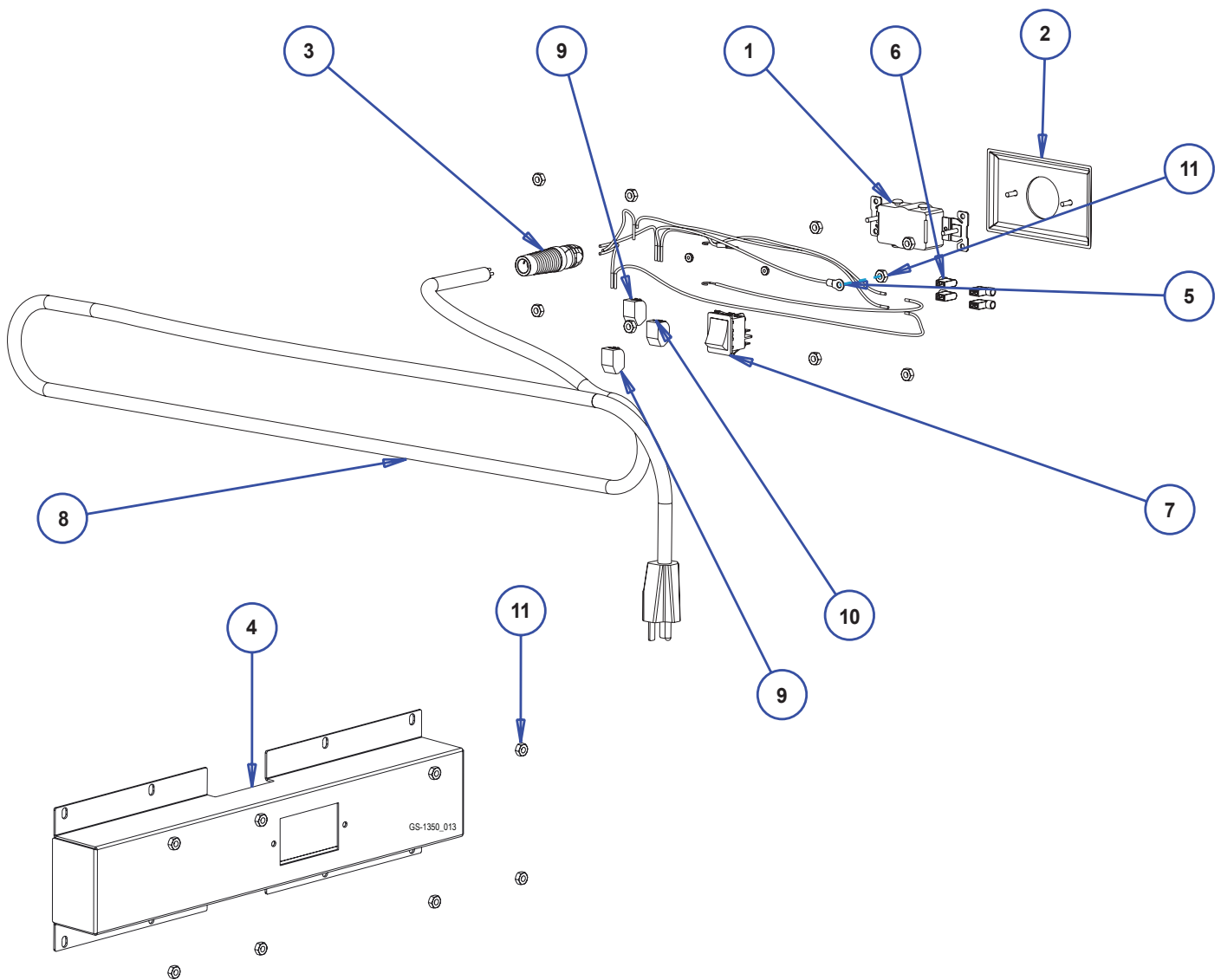

ILLUSTRATED PARTS BREAKDOWN

GS-1350

SEQ	ITEM NO	DESCRIPTION
1	922-T.516R	TUBING, 5/16 IN., RED, PER FOOT
2	925-D40R001-01	GAUGE DIFF PRESSURE 2.5IN 0-1IN H2O PANEL MOUNT
3	926-GS06B	GS FILTER HOLDER 3/8IN
4	926-GS06E	GS FILTER ELEMENT 3/8IN
5	927-05BH	FTG 5/16 PC BULKHEAD
6	927-05MA-06	3/8 PC X 5/16 TUBING
7	927-05T	TEE, 5/16 PC
8	930-136	ZIP TIE BLACK 8-1/2IN WITH MOUNTING HOLE
9	NE08321115-HNSZ	NUT 8-32 X 11/32 LOCK NYLON SS

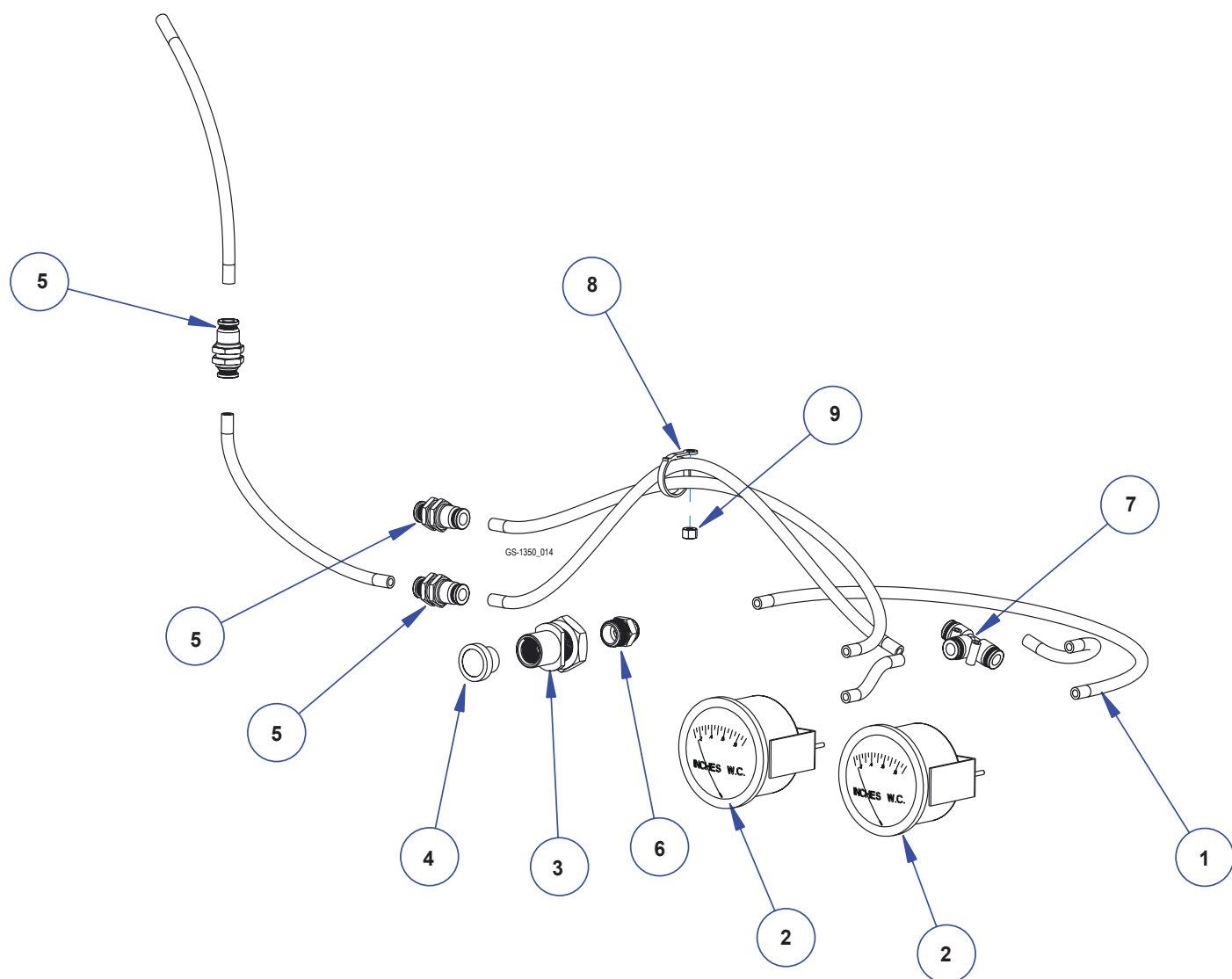

ILLUSTRATED PARTS BREAKDOWN

GS-1350

SEQ	ITEM NO	DESCRIPTION
1	600-SPB10-1	CIN FAN SPB-10 ARRANGEMENT 4
2	900-123N520P-04	CORD 12/3 20A CORD LOCK PLUG, 48IN LONG 5IN STRIP BLACK
3	921G-80SC03	SLIP COUPLING, 5IN ID X 3IN L, ALUMINUM
4	600-SP10-3	TBD

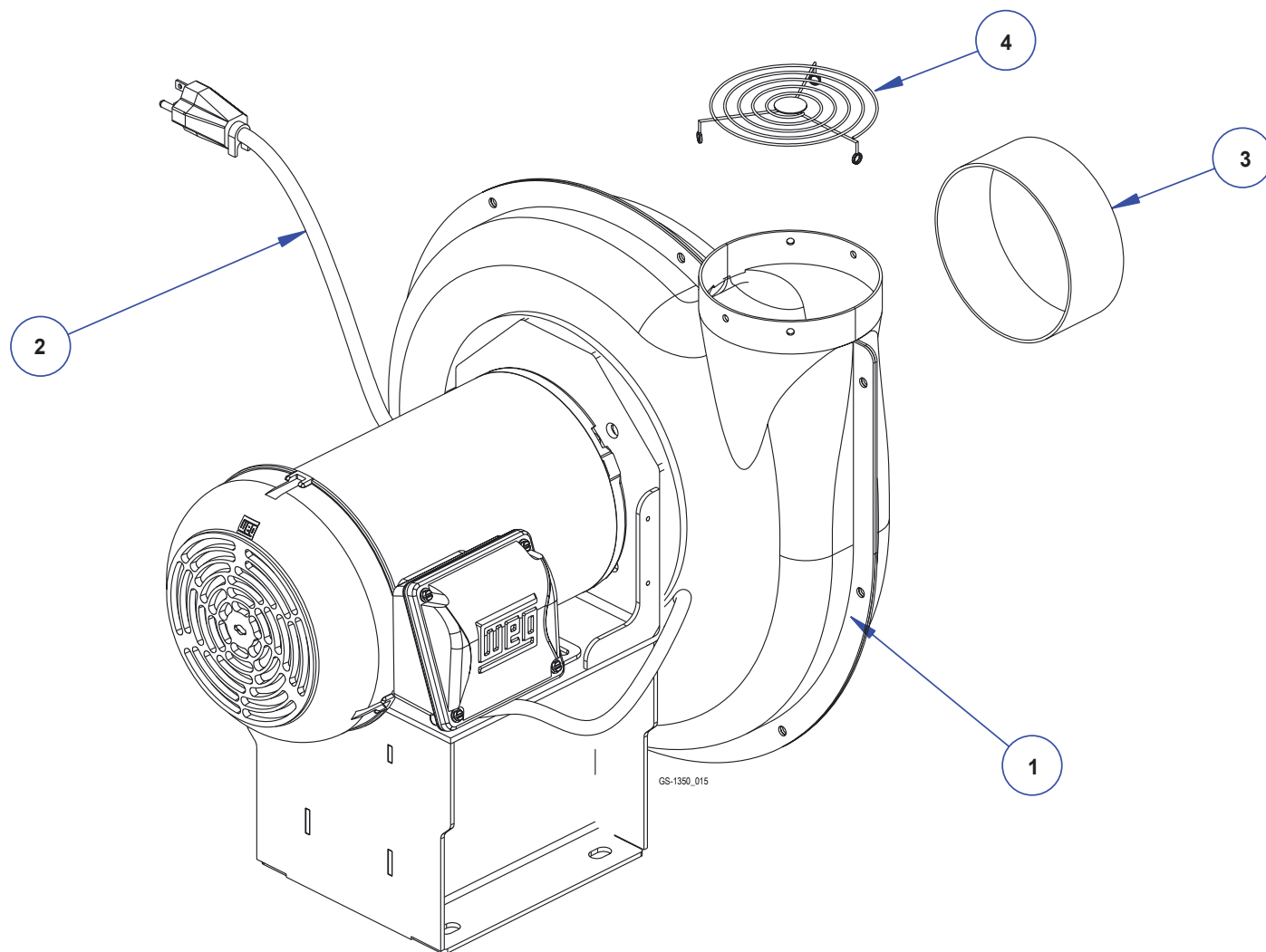

GS-1350_015

LIMITED LIFETIME WARRANTY TERMS AND CONDITIONS

Warranty Terms

Clayton Associates, Inc. guarantees its manufactured products against defects in materials or workmanship and will either repair or replace all parts that prove defective under normal use during the lifetime of the products. The warranty period shall commence from the date of paid invoice.

This warranty does not cover (a) repairs due to normal wear, accident, neglect, misuse, or use other than as indicated in the instruction booklet (b) products manufactured by third parties and distributed by Clayton (c) wear items such as bearings, rotor blades, regulators, valve stems, levers, shrouds, guards, O-rings, seals, gaskets, motor brushes, and other wearable parts.

Repair within the Continental US

During the first 90 days of the warranty period, Clayton will provide parts and labor to the customer's site at no charge or pay freight costs associated with returning the products for repair to a Clayton selected service location and repair the product at no charge. Clayton personnel will determine the best way to repair the product.

Past 90 days, Clayton will provide parts to the customer's site at no charge or the customer may ship the product to a Clayton selected service location at customer's expense and Clayton will repair the product at no charge and provide return shipping.

Repair Outside the Continental US

Clayton will provide parts to the customer's site at no charge or the customer may ship the product to a Clayton selected service location at customer's expense and Clayton will repair the product at no charge and provide return shipping.

Limitation of Liability

Clayton shall not in any event be liable for any damages, loss of production time or profits, whether based on contract, warranty, negligence, strict liability or otherwise, including without limitation any consequential, incidental or special damages, arising with respect to the equipment or its failure to operate.

Clayton Associates, Inc. makes no other warranty or representation of any kind, except that of title, and all other warranties, express or implied, including warranties of merchantability or fitness for any particular purpose, are hereby expressly disclaimed.



Clayton products are proudly made in the USA

